



**PERMIT TO CONSTRUCT**  
Onsite Wastewater System

Permit ID: OSWW007970 v1.0

County: Berkeley

Name: Tyler Sgro  
Type Facility: Residential  
Subdivision:  
Block: Lot: 7

Site: Spring Plains Road  
Cross, SC

Program Code: CONVENTIONAL  
System Code: 100 CONVENTIONAL  
TM #: 0310004051  
Water Supply: Private Well

**PERMIT TO CONSTRUCT SYSTEM SPECIFICATIONS**

Daily Flow (gpd): 480      **Tank Sizes (gal):** Septic Tank: 1000      Pump Chamber:      Grease Trap:  
LTAR (g/d/ft<sup>2</sup>): .6      **Trenches:** Length (ft): 268      Width (in): 36      Max. Depth (in): 31      Agg. Depth (in): 14  
Min Pump Capacity: GPM at ft. of Head

**SPECIAL INSTRUCTIONS/CONDITIONS**

THIS PERMIT IS SITE SPECIFIC. ANY CHANGES TO THE SYSTEM MUST BE APPROVED BY DHEC. ALTERNATIVE TRENCH PRODUCTS APPROVED UNDER STATE RULES AND REGULATIONS MAY BE SUBSTITUTED. ANY UNAPPROVED CHANGES WILL VOID THIS PERMIT.

Installers must contact the local Environmental Affairs office by 10:00 AM the day prior to installation in order to schedule a time for the final inspection. If a Department representative does not arrive within 30 minutes of the scheduled time, the installer may conduct the final inspection. When a contractor self-inspection occurs, the installer must complete DHEC form 3978, Approval to Operate Contractor Self-Inspection. The installer must submit the DHEC form 3978 within 2 business days of the completion of installation.

Self-installations require a pre-construction conference with a Department representative.

- 75' setback from all private wells. 100' setback from public wells.
- All applicable setbacks set forth in Regulation 61-56 apply.
- Do not install under wet soil conditions. Minimum 9" cover over system after installation.
- Do not cut, fill, bulldoze, scrape or change the grade of the natural soils in the septic system area.
- **Permit issued based on soil work and system recommendations from Tyler Sgro. SC PSC # 119.**

**PERMIT TO CONSTRUCT SYSTEM DIAGRAM**

See System Diagram on page 2 of this document.

Issued/Revised By:

Date: July 13, 2023



# PERMIT TO CONSTRUCT

Onsite Wastewater System

Applicant: Tyler Sgro  
Permit ID: OSWW007970 v1.0  
County: Berkeley

## PERMIT TO CONSTRUCT SYSTEM DIAGRAM

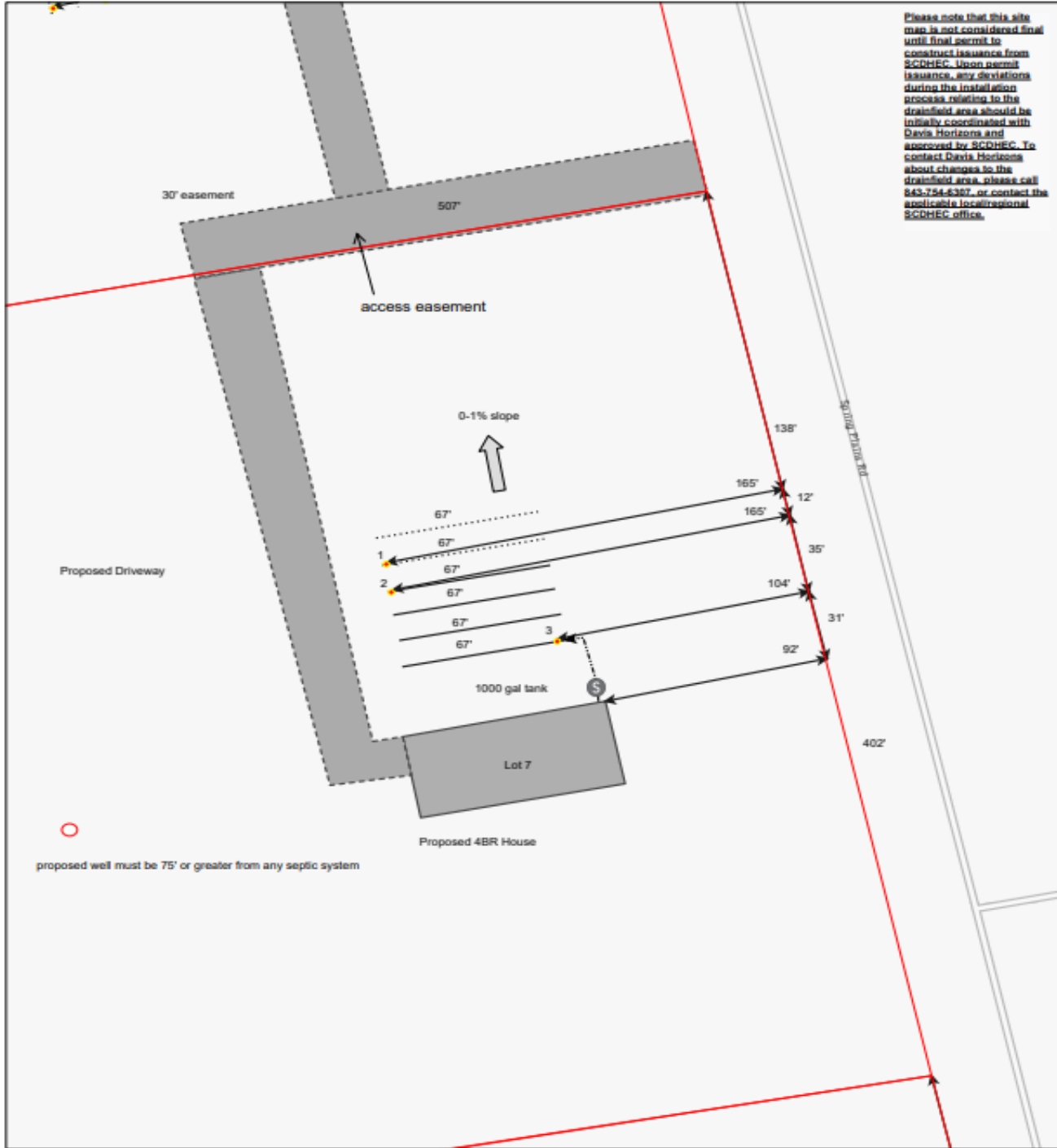

Please note that this site map is not considered final until final permit to construct issuance from SCDHEC. Upon permit issuance, any deviations during the installation process relating to the drainfield area should be initially coordinated with Davis Horizons and approved by SCDHEC. To contact Davis Horizons about changes to the drainfield area, please call 843-754-6307 or contact the applicable local/regional SCDHEC office.

7/6/2023, 1:33:52 PM

- Soil Data Form
- Septic Design Line
- > Distribution Line
- Soils Project Area
- ←→ Distance/Setback
- Septic Design Polygon
- Septic Design Point
- Drain Lines
- House
- ⊙ Septic Tank
- ..... Repair Lines
- Driveway

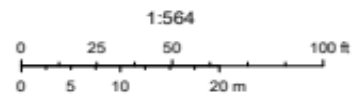

Esri Community Maps Contributors, © OpenStreetMap, Microsoft, Esri, HERE, Garmin, SafeGraph, GeoTechnologies, Inc, MET/NASA, USGS, EPA, NPS, US Census Bureau, USDA